



ES-TRIN CERTIFIED

WATERKING 95 NG-A

AMPHIBIOUS EXCAVATOR

REACH 10,00 m

GROUND PRESSURE 0,131 kg/cm²

CLASS 9,5 ton

ABOUT THE WK 95

OUR STORY

What others saw as impossible, we saw as an opportunity. An amphibious excavator with more freedom of movement and greater work capability. Through its development, Waterking's excavator has set the standard for the next generation of amphibious machines. With our undercarriage, it is no problem at all to work on difficult surfaces. From swamps to waters, anything is possible with the Waterking. We strive to be Ingenious for you.

MATERIALS

The amphibious excavators we make are constructed of Cor-Ten steel and Hardox. This means they are eight times better protected against corrosion than other amphibious machines.

Many different choices of upper structures are possible, including Doosan, Caterpillar, Komatsu, Hitachi, Volvo, Takeuchi, Yanmar, JCB, etc. It is also possible to mount used upper structures as well as your own, on our undercarriages.

GROUND PRESSURE AND CORROSION

Our undercarriages have up to 50% less ground pressure than those of our competitors. We widen our pontoons, contributing to increased stability and buoyancy.

Amphibious excavators are equipped with a shielded tensioning cylinder. With this tracks can be tightened faster and more efficiently and there is less chance of damage and corrosion.

MOTOR, STEERING AND ATTACHMENTS

Heavy-duty travel motors, which is the most powerful travel motor in his class. Which helps to offer greater tractive force.

Third generation tracks with rounded edges, to ensure easy steering and reduction of damage to the surface. Larger side pontoons make it easier to use accessories like large buckets, dredging pumps or powerpacks without affecting the stability of the machine.

ES-TRIN

Since 2021, amphibious excavators officially belong to inland waterway vessels and are therefore required to carry a stability certificate. So CESNI created the ES-TRIN (European Standard Technical Requirements for Inland Navigation vessels). More information and further explanations can be found on the next page.

PACKAGES

NAME

Basic machine

ES-TRIN uncertified

ES-TRIN certified

CONTAINS

Uppercarriage + undercarriage

Basic machine + sidepontoons + spudpoles

Basic machine + sidepontoons + spudpoles + middle pontoon + safety fences

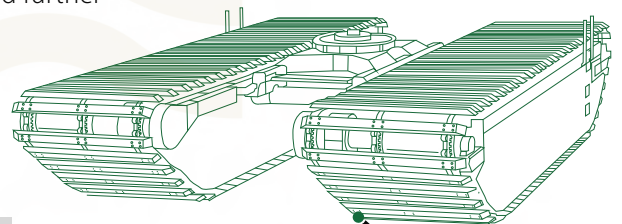

Less groundpressure, strong, more stability and great buoyancy

WK 95 NG-A in Markerwadden, the Netherlands



ES-TRIN

ES-TRIN is a regulatory framework that mandates compliance for vessels and floating equipment intending to navigate or operate on European inland waterways.

If your floating equipment does not comply with the current ES-TRIN regulation, then it is not allowed to perform work on European inland waterways.

Accidents happen in every field. However, everyone wants to prevent them as much as possible, which is why in 2015 CESNI was founded by the CCNR (Central Commission for Navigation of the Rhine). The CESNI aims to centralize technical standards in different fields. In the image on the right, you can see where ES-TRIN is mandatory.



- ES-TRIN MANDATORY
- ES-TRIN VALID, NOT MANDATORY
- 🕒 THE RHINE

The difference between an ES-TRIN certified amphibious excavator and an uncertified one is the stability. A certified one is equipped with wider side pontoons, a middle pontoon and safety fences. These ensure the safety of the machine and reduce the chance of capsizing.

At Waterking, we meticulously test each machine for maximum inclination, steel thickness, and corrosion, ensuring a thorough examination of their durability and performance.

Would you like to know more information about ES-TRIN? Contact our Sales team!

✓ WHY ES-TRIN CERTIFIED

- Complies with laws and regulations
- Deployable anywhere
- Safety guaranteed
- Gives working comfort

✗ WORKING WITHOUT ES-TRIN

- Unsafe work environment
- Accident risk
 - Personal injury
 - Environmental damage
 - Equipment damage
- Project shutdown
- Financial risk

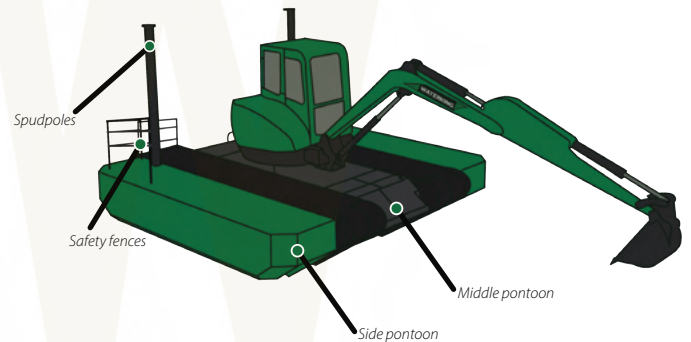

ES-TRIN certified amphibious excavator

CERTIFIED AND UNCERTIFIED

A certified machine has:

- Wider side pontoons
- A middle pontoon
- Safety fences
- Stronger drive motor

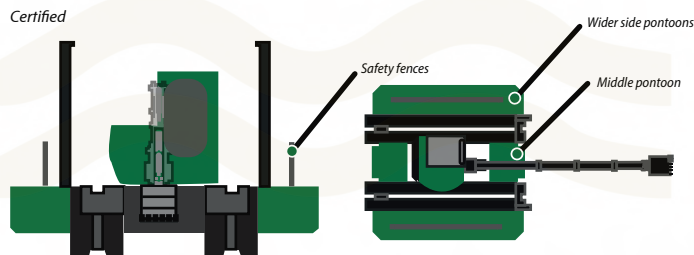

An uncertified machine has:

- Smaller side pontoons
- No middle pontoon
- No safety fences

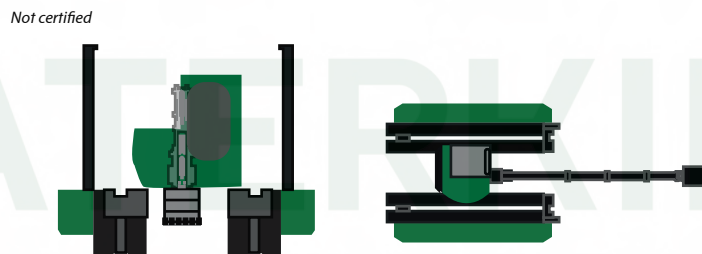

ES-TRIN certified WK 95 NG-A



OPTIONS AND ATTACHMENTS

UNPERFORATED BUCKETS

Unperforated digging buckets are used to dig sand. They are made of hard steel and can also come with teeth (teethbucket) to get through hard surfaces.

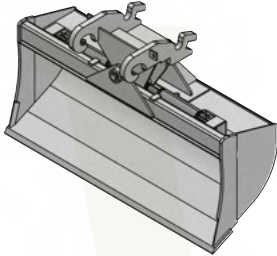

PERFORATED BUCKETS

Full- and half-perforated digging buckets are often used for dredging. The holes allow the water to drain out and the silt remains.

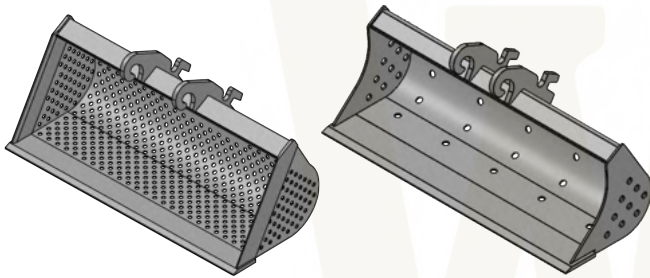

RAKES

Rakes are used to level substrates or remove exotics from water, for example.

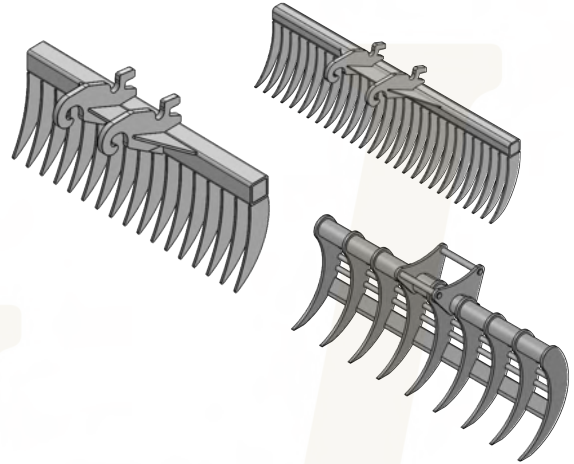

MOWING BUCKET

A **mowing bucket**, consisting of a bucket with cutting blades to remove vegetation from an embankment or water bottom.

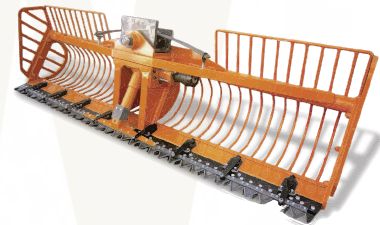

MECHANICAL TREE CUTTERS

Tree cutters are used to prune and cut both large and small trees with ease.

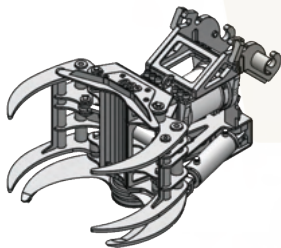

QUICK-HITCH

A **quick-hitch** is used to switch quickly between buckets and other attachments.



CUSTOMIZATION

It is entirely up to you, as the customer, to assemble the machine yourself. This of course includes attachments. Waterking supplies various types and sizes of attachments as visualized above.

Attachments to be powered by a hydraulic powerpack are listed later in the brochure.

WATERKING

TECHNICAL SPECIFICATIONS

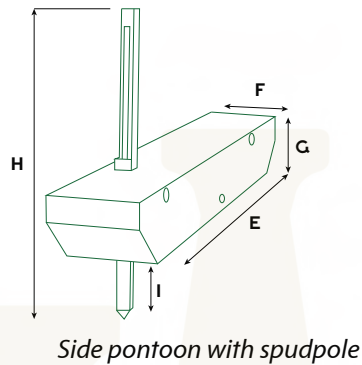
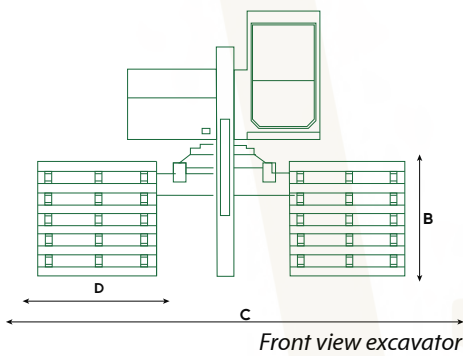
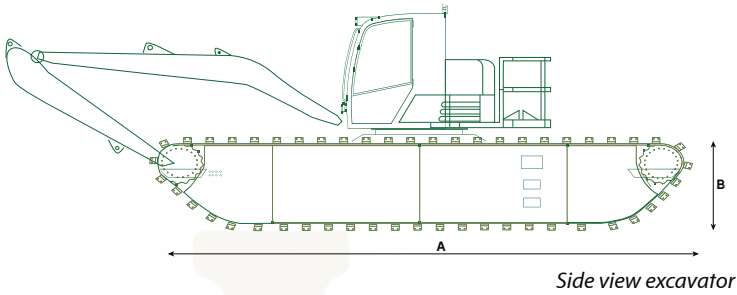

Excavator class - ton	9 - 10
Total weight - ton	16,50
Reach - m	6,50 - 10,00
Weight pontoon set - ton	10,00
Groundpressure - kg/cm2	0,131
Engine power - kW	40,7 - 56,5
Bucket- l	20 - 400
A Length pontoon - m	8,60
B Height pontoon - m	1,38
C Undercarriage overall width - m	4,20
D Pontoon width - m	1,35
Tracks - m	PE
E Additional pontoon length - m	8,00
F Additional pontoon width - m	1,22
G Additional pontoon height - m	1,09
Additional pontoon weight (each incl. spud pole) - kg	2.050
H Spud pole length - m	6,00
I Spud pole stroke length - m	4,91

REACH CAPACITY

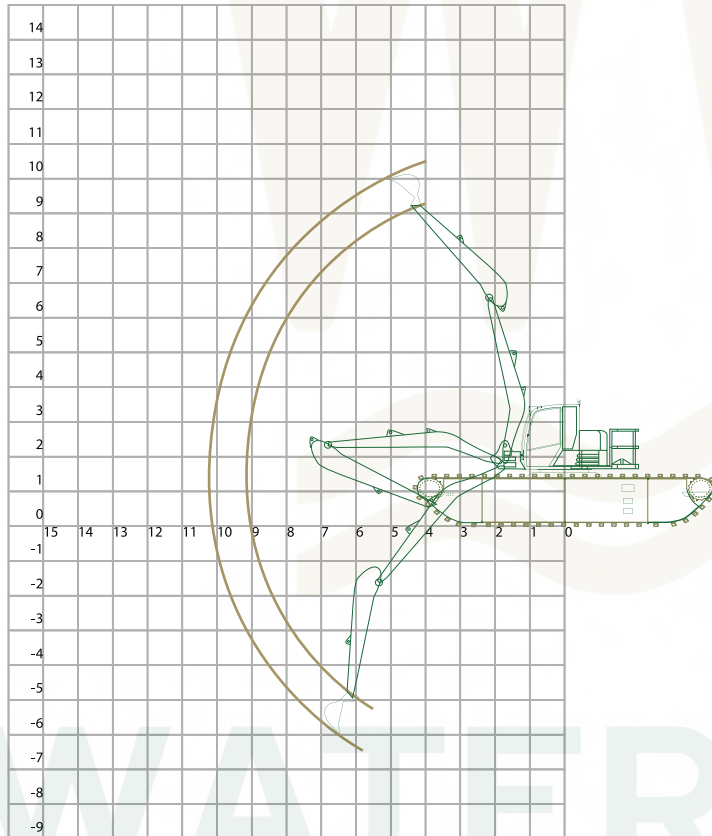

WATERKING

WK 95 NG-A in Hunze en Aa, the Netherlands



TRANSPORT

The WK 95 NG-A is an adjustable excavator. Not only in the work field but also for transportation this has a lot of advantage. The basic machine can be transported on 1 trailer, the ES-TRIN certified and uncertified on 2 trailers. If necessary, the upperstructure, undercarriage and boom can also be disconnected, that way everything can fit in a container or on a flatrack

The transport of the excavator can be completely arranged by Waterking

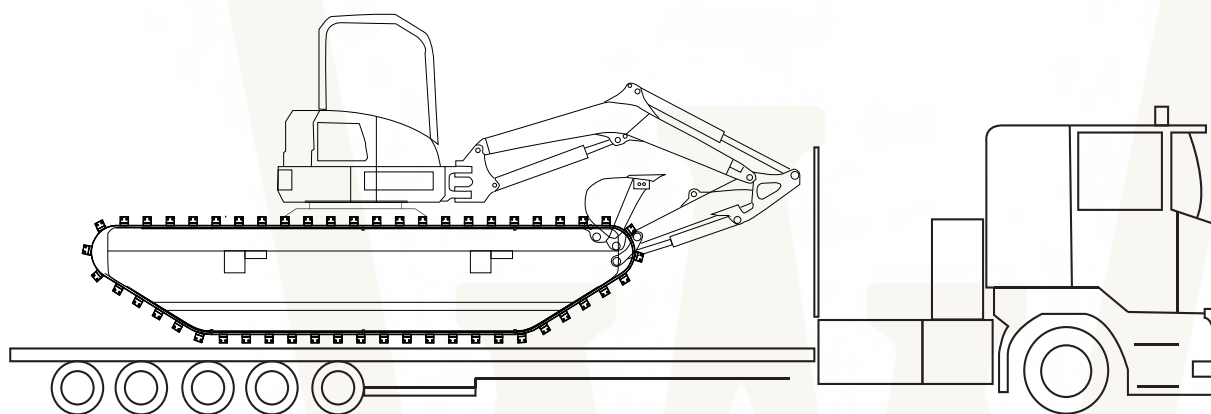

TYPE

Basic machine

Uppercarriage + undercarriage

ES-TRIN uncertified

Uppercarriage + undercarriage + spudpoles + side pontoons

ES-TRIN certified

Basic machine + sidepontoons + spudpoles + middle pontoon + safety fences

AMOUNT OF TRAILERS

1 trailer

2 trailers

2 trailers

WATERKING BV

POSTAL ADDRESS

MERCURIUSWEG 22 | 9482 WLTYNAARLO | THE NETHERLANDS

VISITORS ADDRESS

MERCURIUSWEG 22 | 9482 WL TYNAARLO | THE NETHERLANDS

SALES@WATERKING.NL | WWW.WATERKING.NL | +31 (0)592 - 55 95 36



INGENIOUS FOR YOU

MERCURIUSWEG 22 | 9482 WL TYNAARLO | THE NETHERLANDS
SALES@WATERKING.NL | WWW.WATERKING.NL | +31 (0)592 - 55 95 36